

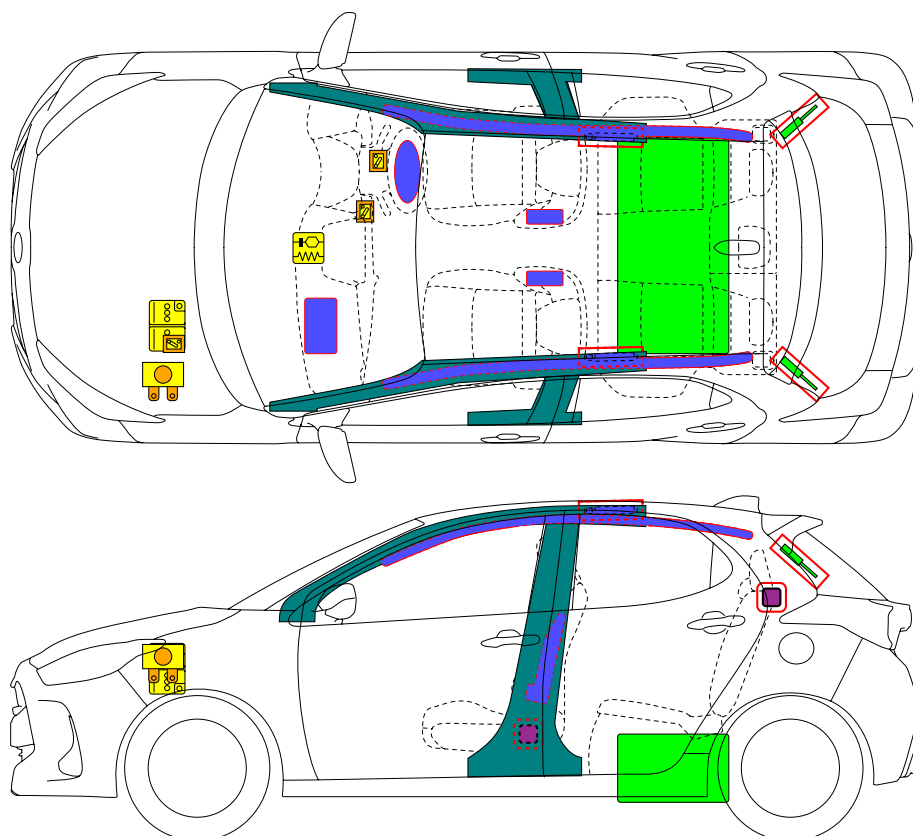

TOYOTA YARIS

2020-5



| | | | | | | | | | |
|---------|--|-------------|--------------------------------------|--------------|-------------------------|-------|--|--|-------------------------------------|
| | Airbag | | Stored gas inflator | | Seat belt pretensioner | | SRS control unit | | Pedestrian protection active system |
| | Automatic rollover protection system | | Gas strut / Preloaded spring | | High strength zone | | Zone requiring special attention | | |
| | Battery low voltage | | Ultra capacitor, low voltage | | Fuel tank | | Gas tank | | Safety valve |
| | High voltage battery pack | | High voltage power cable / component | | High voltage disconnect | | Fuse box disabling high voltage system | | Ultra capacitor, high voltage |
| | Low voltage device that disconnects high voltage | | | | | | | | |
| ID No. | | Version No. | | Version date | | Page | | | |
| YARIS10 | | 01 | | 05 / 2020 | | 1 / 4 | | | |

1. Identification / Recognition

■ Location of vehicle badges

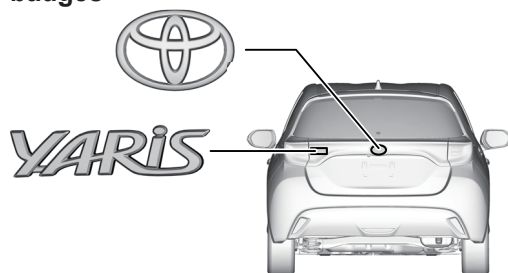

2. Immobilisation / Stabilisation / Lifting

■ Completely immobilize the vehicle

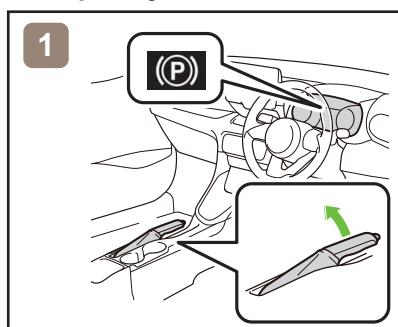

1. Chock the wheels and engage the parking brake.

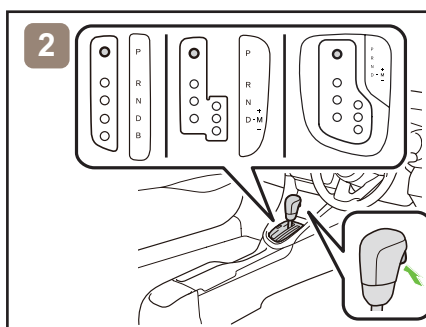

2. Move the shift lever to the park (P) position.*1

*1: CVT

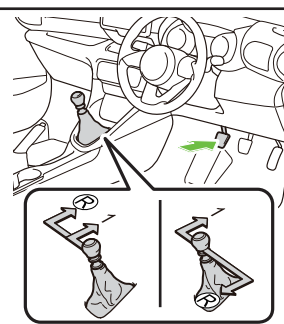

2. Move the shift lever to the 1st or reverse (R) position.*2

*2: M/T

■ To stabilize the vehicle, place cribbing such as wooden blocks at the four points under the front and rear pillars.

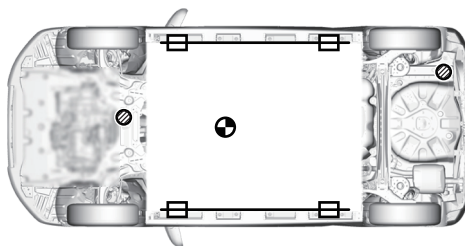

Jack Position



Support Position



Vehicle Center of Gravity



Do not place cribbing such as wooden blocks or rescue air lifting bags under the exhaust system or fuel system. Doing so may result in fuel leaks, fire, or electric shock.

3. Disable direct hazards / Safety regulations



Even if the engine is stopped, the vehicle may not be shut off. If the vehicle is not completely shut off, the engine may suddenly start or the vehicle may start to move.

■ If any of the following systems are required to be operated, operate them **BEFORE** disconnecting the battery.

Power door lock

Power window

Back door opener



When the 12 V battery is disconnected, electrical components cannot be operated.

| ID No. | Version No. | Version date | Page |
|---------|-------------|--------------|-------|
| YARIS10 | 01 | 05 / 2020 | 2 / 4 |

■ Perform procedure 1 or 2 to completely shut off the vehicle.

<Procedure 1>

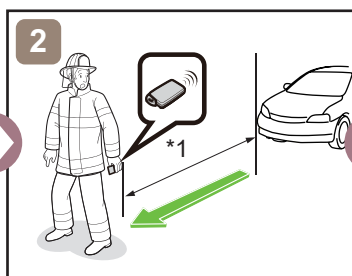
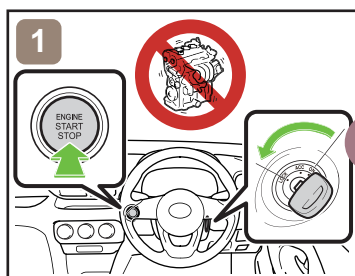
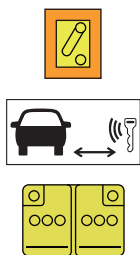

*1: 5 m (16.4 ft) or more

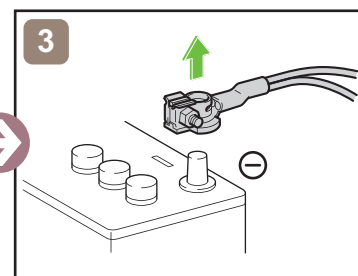

<Procedure 2>

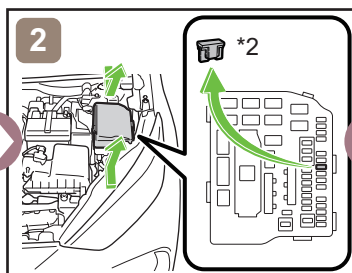
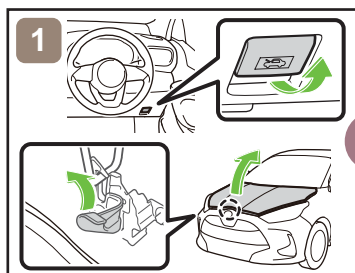
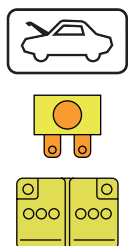

*2: IGP-MAIN FUSE (25 A CLEAR)

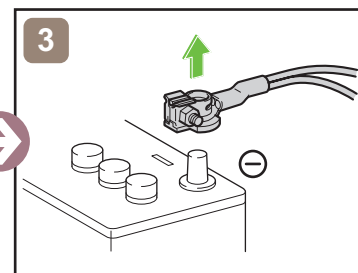

■ Access to 12 V Battery

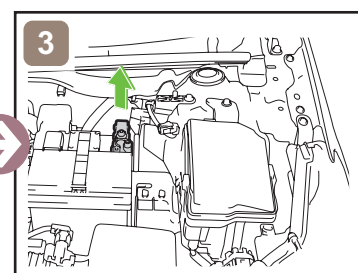
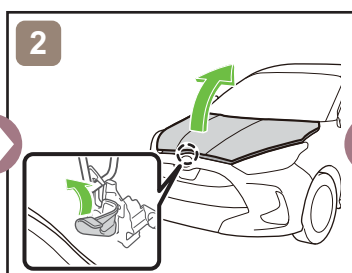
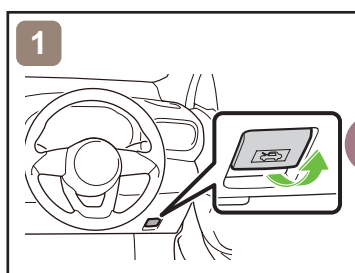
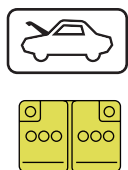

4. Access to the occupants

■ Window Glass

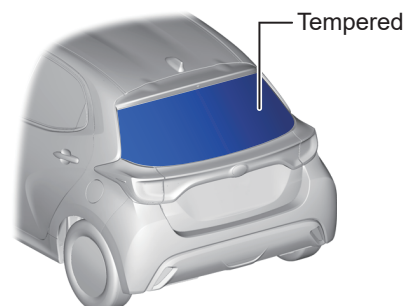
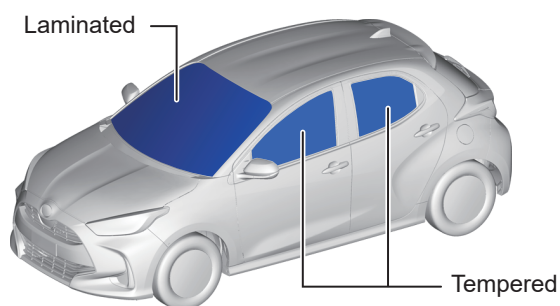

| ID No. | Version No. | Version date | Page |
|---------|-------------|--------------|-------|
| YARIS10 | 01 | 05 / 2020 | 3 / 4 |

5. Stored energy / Liquids / Gases / Solids



12 V Battery



Gasoline Tank: 40 L, 42 L



Always wear appropriate personal protective equipment (PPE) when dealing with any of these items.

6. In case of fire



RE-IGNITION POSSIBLE !

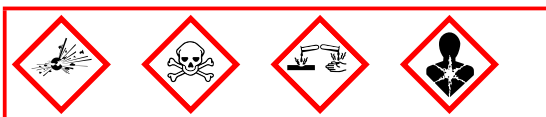

7. In case of submersion



Work on the vehicle only after the vehicle has been pulled out of the water.

8. Towing / Transportation / Storage

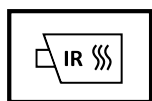
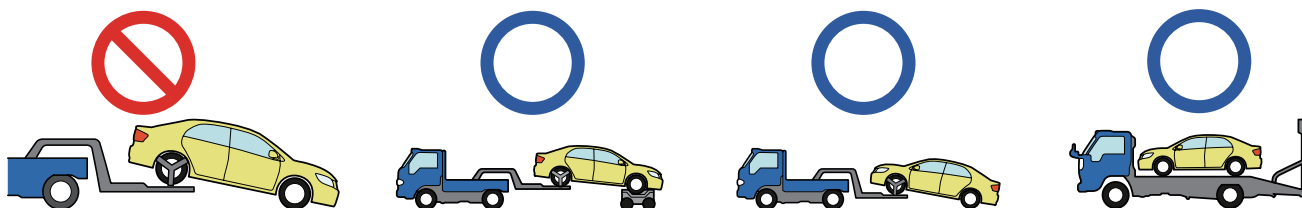

RE-IGNITION POSSIBLE !

Store the vehicle at a safe distance (15 m (49.2 ft) or more) from other vehicles.

9. Important additional information

For further details, please refer to "Emergency Response Guide".
<https://www.toyota.co.nz/owners/vehicle-documents/2020/emergency-response-guide/>

| ID No. | Version No. | Version date | Page |
|---------|-------------|--------------|-------|
| YARIS10 | 01 | 05 / 2020 | 4 / 4 |